



Portman Street, Middlesbrough

OIRO £80,000 Freehold

High yield, turnkey BTL in TS1

Description

This is a good-sized 2 bedroom terrace a very the central and popular part of Middlesbrough. Currently let at £600 pcm to a fully-referenced tenant, an 9 % yield at the asking price, this investment property comes with professional management in place and the benefit of an underwritten rent guarantee for up to 15 months of rent (full details available on request from the agent).

Please view the recent virtual 360 tour.

Entering the house along a welcoming hallway you will turn left into the spacious living/diner room. Currently set up with a lounge space to the front and a hobby space to the rear with is a great sized room with new UPVC double glazing.

At the rear is a good sized fitted kitchen with boiler, electric hob and oven and modern worktops with base units.

Upstairs is the family bathroom with bath and over head shower, glass screen, basin and low level WC. With a towel radiator for heat and new double glazed obscured glass windows.

At the front of the house is a spacious double bedroom which is light and airy creating a welcoming relaxing aura. New windows and carpets.



The second room is another double facing the rear of the property. Currently used as a spare room it is large enough for a double bed and wardrobe. Again, there is a double glazed window and the floor is carpeted.

Externally is a nice rear yard that has been gravelled with a beamed awning creating a great outdoor space for an evening drink. With gates to the rear alley.

Tenant pays rent on time and there are no arrears. Sale is to reduce portfolio.

Council Tax Band: A

Tenure: Freehold

Electricity supply: Mains

Heating: Gas Mains

Water supply: Mains

Sewerage: Mains

Tenure

Freehold

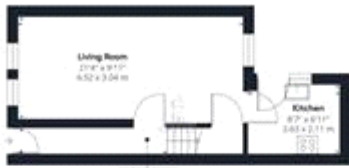

Floor 0



Floor 1

 CASTLE
 Representative total area:
 20,827
 20,274 m²
 20,827
 20,274 m²
 20,827
 20,274 m²

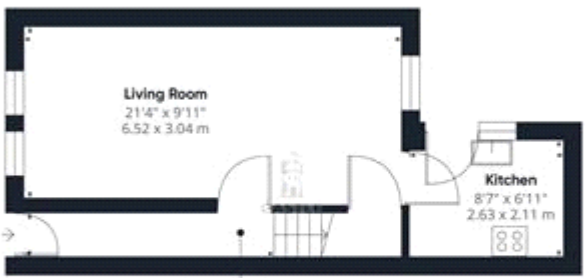

Floor 0

 CASTLE
 Representative total area:
 20,827
 20,274 m²
 20,827
 20,274 m²
 20,827
 20,274 m²

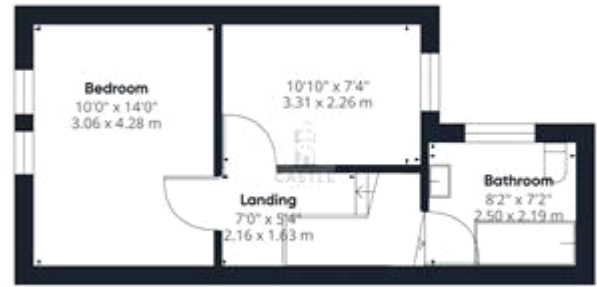

Floor 1

 CASTLE
 Representative total area:
 20,827
 20,274 m²
 20,827
 20,274 m²
 20,827
 20,274 m²



Energy Efficiency Rating		
	Current	Potential
Very energy efficient - lower running costs		
(92-100) A		
(81-91) B		85
(69-80) C		
(55-68) D	60	
(39-54) E		
(21-38) F		
(1-20) G		

Viewing by appointment only
 Castle Homes - Head Office
 1 Lingfield Close, Darlington, County Durham DL1 1YG
 Tel: 0330 124 8889 Email: info@castlehomesproperty.co.uk Website:
<https://www.castlehomesproperty.co.uk>

